



9 Albert Embankment, London
SE1

GARTON JONES.COM



9 Albert Embankment, London , SE1

GARTON JONES.COM

9 Albert
Embankment
London
SE1 7SP

Sales +44 (0) 20 7735 1888
nineelms@gartonjones.com
www.gartonjones.com

£595 Per Week

A spacious 1-bedroom, 1-bathroom Penthouse apartment of 545sq.ft (50sq.m) available to rent in 9 Albert Embankment, a popular modern development on the banks of the River Thames. The property has full width floor to ceiling windows in all principal rooms and enjoys un-rivalled views of the City of London taking in the Houses of Parliament, St Pauls Cathedral and beyond. Additional benefits include a 24-hour porter, balcony, wood flooring, on-site convenience store and secure underground parking (available under separate negotiation). The rail/tube links of Vauxhall are within walking distance and there is also an excellent bus service on the doorstep. London's South Bank with its popular tourist attractions, restaurants and cafes is also close by.

*Please note furniture may differ to that shown in the current photos.

- Electricity Supply — Mains | Water Supply — Mains | Sewerage — Mains | Heating — Electric Radiators
- Broadband & Mobile Signal : Check Coverage via Ofcom
- Parking: Available Under Separate Negotiation
- Lift Access
- Building Safety: EWS1 Available on Request
- Council Tax Band E (London Borough of Lambeth)
- 5 Week Security Deposit
- Holding deposit equivalent to 1 week of rent
- Rent to be payable monthly in advance
- EPC Rating C (73)

- 1 Bedroom
- 545sq.ft (50sq.m)
- 1 Bathroom
- Open Plan Reception
- Modern Integrated Kitchen
- Balcony
- Good Storage
- 24 Hour Concierge
- Bike Storage
- 0.5 Miles to Vauxhall Station



EPC certificate available on request.

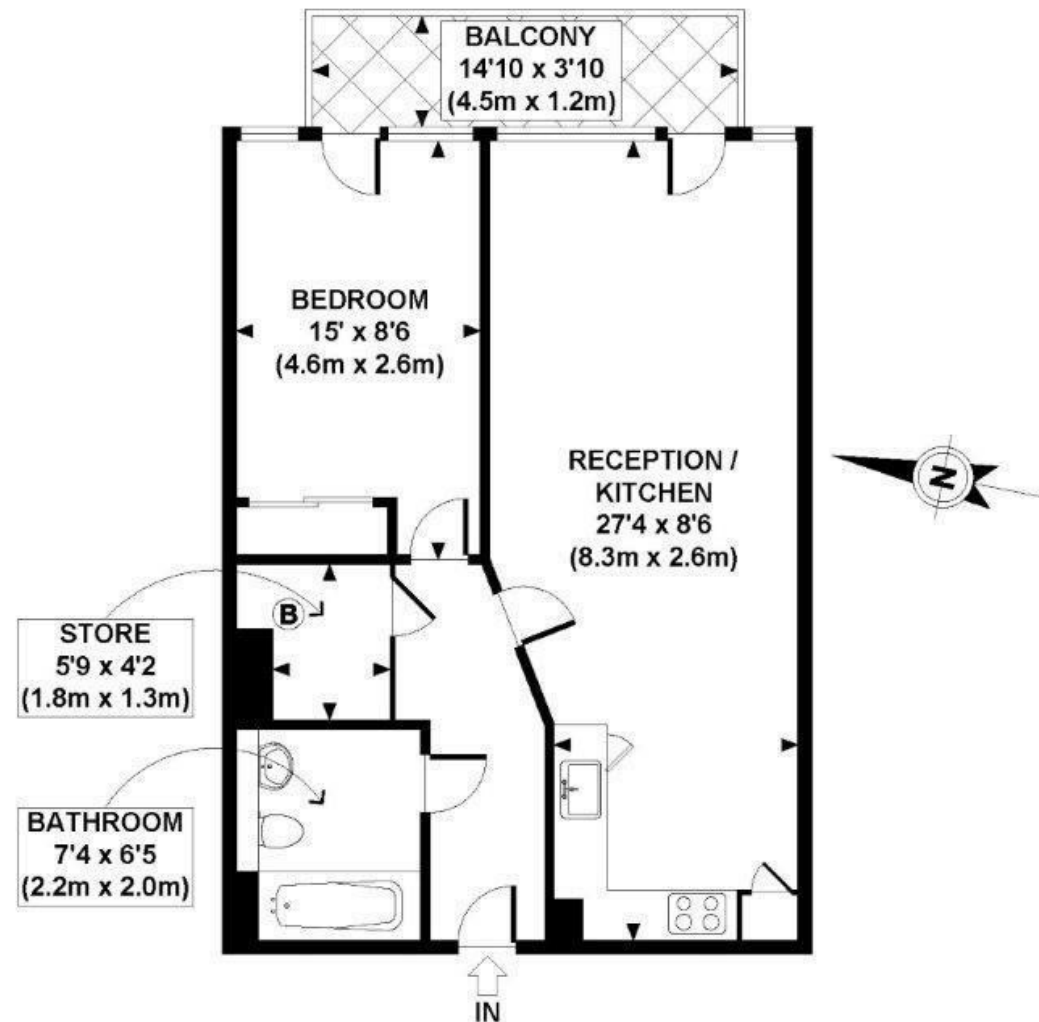

THIRTEENTH FLOOR
GROSS INTERNAL
FLOOR AREA 545 SQ FT

APPROX. GROSS INTERNAL FLOOR AREA 545 SQ FT / 51 SQ M

